

Description

ND-37 pressure transducers ensure long-term minimization errors that persist after millions of cycles of maximum overpressure. The sensor and the process connection are worked as one body, consequently the new ND-37 transducer has a stronger and more robust structure compared to any other transducer, this makes it more resistant also to sudden water hammer in difficult working conditions. Available with different process connections and pressure ranges according to customer needs, the pressure transducer Nava ND-37 offers proven reliability at an affordable price.

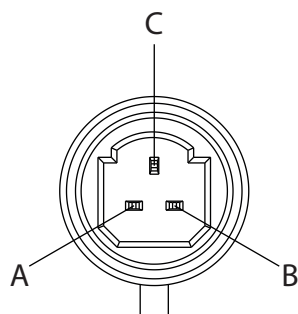

Electrical connection :

Power Supply	5V, 8 ~ 30VDC	8 ~ 30VDC
Output	0,5 ~ 4,5V 0 ~ 5V 1 ~ 5V	4 ~ 20mA
A	VDD	SUPPLY (+)
B	GND	NC
C	OUTPUT	SUPPLY (-)

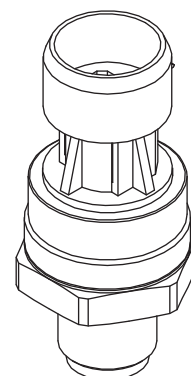
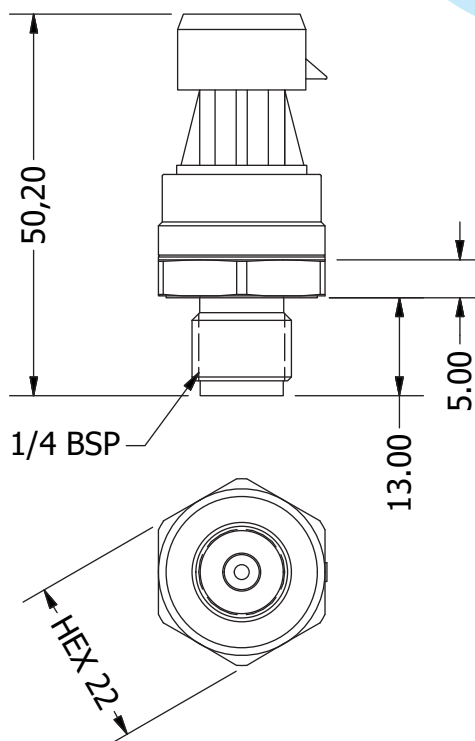

Technical features

Accuracy: $\pm 0,5\%$ F.S.
Hysteresis, Repeatability': $\pm 0,1\%$ F.S.
Working temperature: $-40\text{ }^{\circ}\text{C} \dots +125\text{ }^{\circ}\text{C}$
Temperature compensation: $-20\text{ }^{\circ}\text{C} \dots +80\text{ }^{\circ}\text{C}$
Total error band: $\pm 1,5\%$ F.S.
Response time: 2ms
Work cycles: 1 millions cycles
Vibrations: 200m/s^2 [10 ~ 2000MHz]
Weight: 45g

Pressure range

Relative pressure: 0~50 bar / 0~100 bar / 0~200 bar
 0~250 bar / 0~400 bar / 0~500 bar
Overpressure: 2 times the full scale value
Burst pressure: 10 times the full scale value

Electrical features

Output: 4 ~ 20mA 0,5~4,5V / 0~5V / 1~5V
Power supply: 8 ~ 30VDC 5V, 8 ~ 30VDC
Insulation resistance: $> 100\text{M}\Omega$
Tension resistance: 500 V AC (1 minute between case and all terminals tied)

Short-circuit protection: Yes

Construction features

Body material: AISI 303
Wetted port material: AISI 630
Connection: Packard connector
Waterproof IP rating: IP67
Electric connection material: PA66 + GF30 gold plated Pin

Opzioni

Process connections available on request
 Pressure ranges available on request
 Different connection available

Applications

Process control
 Pneumatic and hydraulic Compressors
 Agricultural technology
 Environmental control system
 Air conditioning
 Refrigeration (HVACR)

Ordering information

Pressure range / Process connection / Output signal / Electrical connection / Options